



Multi Split Systems

Reverse Cycle,
Inverter Air Conditioner



Exclusively distributed by



As a global leader in comfort solutions, Lennox® Inverter Multi Split Systems are designed for all-year-round comfort, reliability and energy efficiency.



Around the world, Lennox is a respected leader in climate control solutions. With a long history of technical innovation, Lennox has been heating and cooling homes and offices around the globe for over 120 years.

The Lennox range of Inverter Multi Split Systems has been designed to deliver comfort all year round. Customise the perfect solution with the choice of wall split, mini cassette or slimline ducted for up to 5 rooms in your home or office.

Backed with a 5-year warranty for residential applications, you will have peace-of-mind that Lennox air conditioners provide you with years of trouble free operation.



Slimline Ducted

The slimline ducted can be installed in low roof / bulkhead spaces, making it the ideal choice for discreet whole of home comfort.



Wall Split

Stylish and functional, the wall split is ideal for single rooms or large open plan spaces.

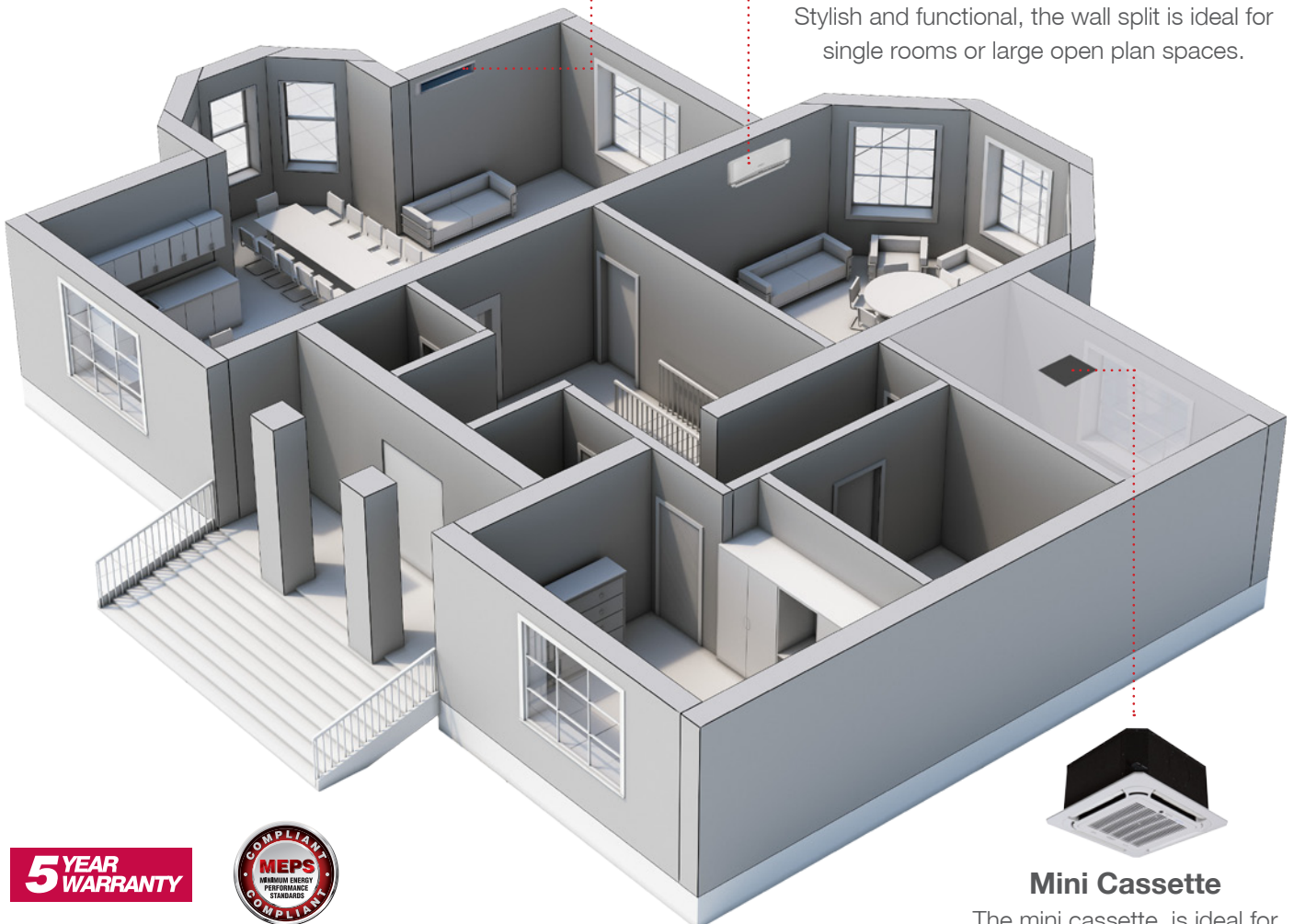

Mini Cassette

The mini cassette is ideal for installations with tight roof / ceiling spaces.

5 YEAR WARRANTY





Designed for flexibility,
Lennox Inverter Multi Split Systems
can heat or cool up to 5 rooms



Mini Cassette

The mini cassette is ideal for installations with tight roof / ceiling spaces.



Wall Split

Stylish and functional, the wall split is ideal for single rooms or large open plan spaces.

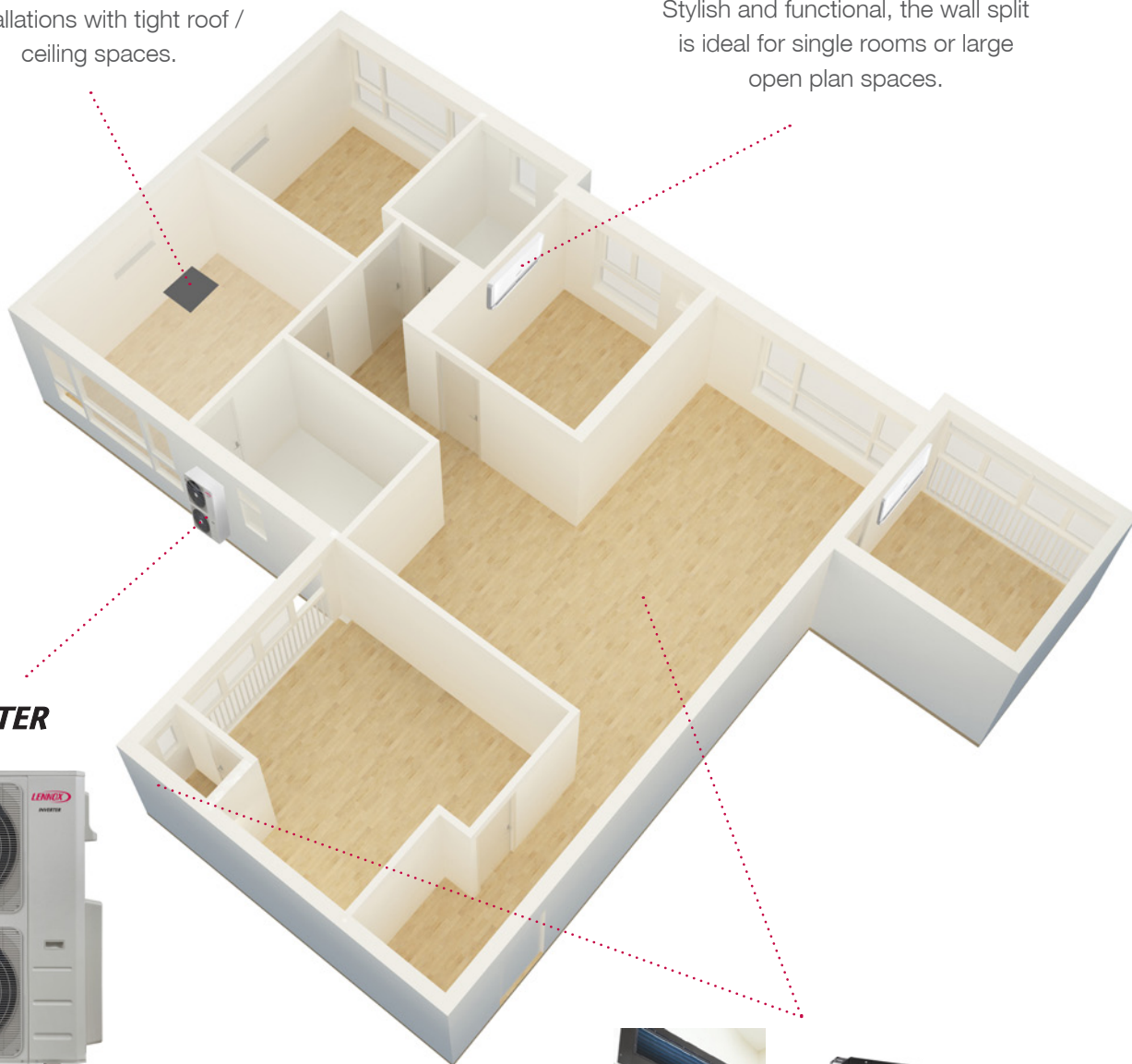

INVERTER



Outdoor Unit

The reverse-cycle inverter outdoor unit is connectable for up to 5 indoor units

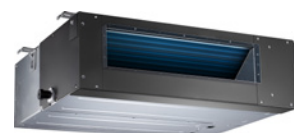

Slimline Ducted

The slimline ducted can be installed in low roof / bulkhead spaces making it the ideal choice for discreet whole of home comfort.

5 YEAR WARRANTY



Max 2 indoor units

LNMT052V2

Cooling capacity 5.2kW

Heating capacity 5.7kW



Max 3 indoor units

LNMT075V2

Cooling capacity 7.5kW

Heating capacity 8.0kW



2 to 4 indoor units

LNMT086V2

Cooling capacity 8.6kW

Heating capacity 9.6kW



2 to 5 indoor units

LNMT106V2

Cooling capacity 10.6kW

Heating capacity 11.0kW

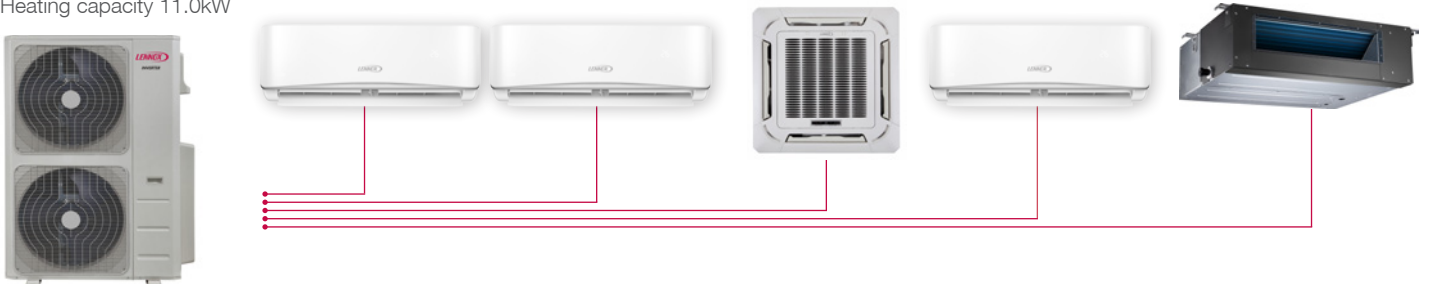

2 to 5 indoor units

LNMT135V2

Cooling capacity 13.5kW

Heating capacity 14.5kW

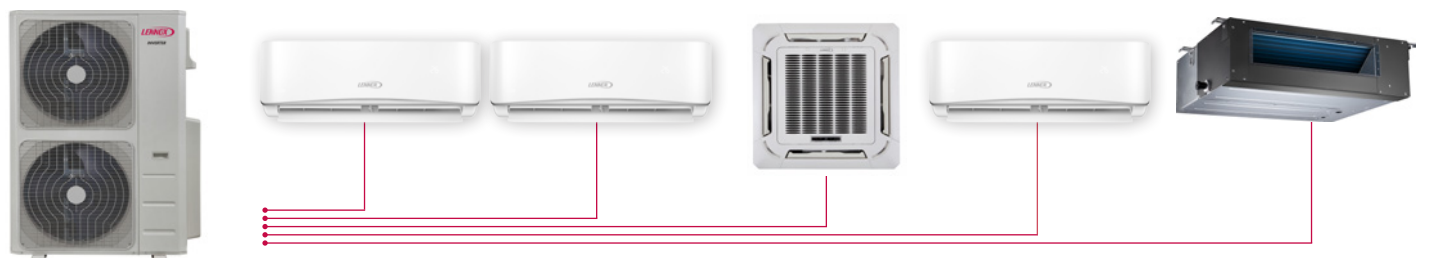

Multi Split System

Reverse Cycle Inverter

The Lennox Inverter Multi Split System is designed for maximum flexibility and comfort while minimising running costs.

Customise the perfect comfort solution with the choice of a wall split, mini-cassette or slimline ducted indoor unit for up to 5 rooms in your home or office.



Features & Benefits

Advanced inverter technology achieves better temperature control with less running costs

Advanced inverter technology can vary the system capacity to better match the heat load of your room.

This delivers:

- Faster, more powerful cooling and heating when you need it most
- Better temperature control
- Lower running costs when compared with traditional fixed speed systems.

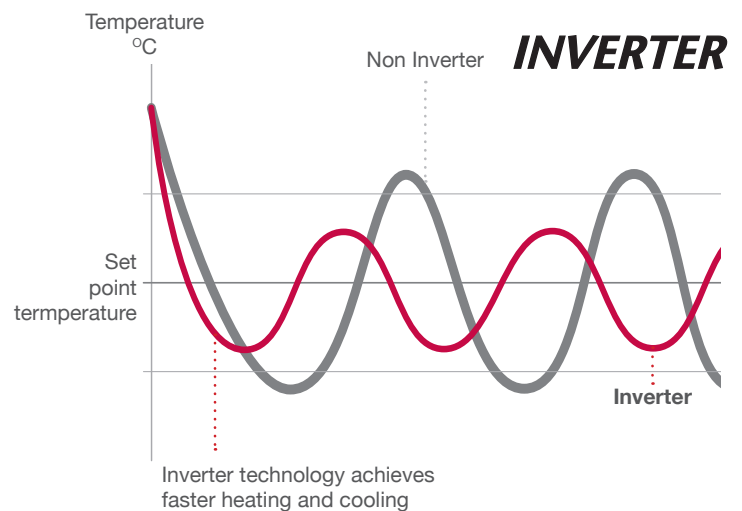

Engineered to perform

The Lennox Inverter Multi Split System has been engineered to perform in the harshest conditions with a superior operating range of up to +50°C and down to -15°C ambient, to provide continuous operation during heatwaves and coldsnaps.

Peace of mind

The Lennox Inverter Multi Split System is backed with a 5 year warranty. All units are Minimum Energy Performance Standard (MEPS) compliant and manufactured in an accredited ISO9001 Quality Assurance System environment.



Self-diagnosis and auto-protection



Auto Defrosting



Emergency Usage Function



Refrigerant Leakage Detect



5 Grades Outdoor Fan Speeds



Blue Fin Corrosion Protection for Coils



Demand Response Enabling Device Compatible (on ODU)

Outdoor Unit

Performance Specifications*

Model Number (Reverse Cycle)	Outdoor Unit	Units	LNMT052V2	LNMT075V2	LNMT086V2	LNMT106V2	LNMT135V2
Maximum Number of Indoor Units		Qty	2	3	4	5	5
Connectable Capacity Range of Indoor Units - Cooling/Heating		kW (Min. - Max.)	2-7.6	2-11.1	2-11.6	2-15.1	2-18.1
Cooling	Capacity	kW	5.20	7.50	8.60	10.60	13.50
	Power Input	kW	1.55	2.10	2.50	3.10	3.75
	Rated Current	A	6.80	9.20	10.90	13.50	12.00
	AEER	W/W	3.27	3.47	3.36	3.33	3.52
	Star Rating	SRI	2.0	2.0	2.0	2.0	2.5
Heating	Capacity	kW	5.7	8	9.6	11	14.5
	Power Input	kW	1.62	2.25	2.7	3.18	4.1
	Rated Current	A	7.1	9.8	11.4	13.8	17.9
	ACOP	W/W	3.42	3.45	3.47	3.37	3.47
	Star Rating	SRI	2.0	2.0	2.0	2.0	2.0
Maximum Power Input		W	3200	3400	3500	4700	5600
Maximum Current		A	14.5	16.5	17	22	27
Starting Current		A	3.0	4.0	4.0	4.5	4.5
Power Supply		V-ph-Hz	220~240-1-50	220~240-1-50	220~240-1-50	220~240-1-50	220~240-1-50
Compressor	Design	Type	Rotary DC	Rotary DC	Rotary DC	Rotary DC	Rotary DC
	Brand	Make	GMCC	GMCC	GMCC	GMCC	GMCC
	Input Power	W	1170	1970	1970	2600	3520
	Rated Current (RLA)	A	8.1	6.95	6.95	5.1	13.4
Outdoor Fan Motor	Input	W	50 (Output)	120 (Output)	120 (Output)	120 (Output)	85 (Output)
	Speed	r/min	750	800	800	800	800
Outdoor Coil	Number of Rows	Qty	2	2	2	2	2
	Tube Pitch(a) x Row Pitch(b)	mm	25.4x22	25.4x22	25.4x22	25.4x22	25.4x22
	Fin Spacing	mm	1.4	1.5	1.5	1.5	1.4
	Fin Type (code)	Material	Hydrophilic Aluminium	Hydrophilic Aluminium	Hydrophilic Aluminium	Hydrophilic Aluminium	Hydrophilic Aluminium
	Tube OD & Type	mm	Ø9.52, inner groove tube	Ø9.52, inner groove tube	Ø9.52, inner groove tube	Ø9.52, inner groove tube	Ø9.52, inner groove tube
	Coil Length x Height x Width	mm	614x660x44	780x762x38.1	780x762x38.1	780x762x38.1	757x660x38.1
	Number of Circuits	Qty	3	5	5	5	10
Outdoor Air Flow		L/Sec.	777	1000	1000	1000	2000
Outdoor Noise Level		dB(A)	60	60	61	64	64
Outdoor Noise Level (Sound Power)		dB(A)	67	69	69	73	73
Outdoor Unit	Dimensions (WxDxH)	mm	845x363x702	946x410x810	946x410x810	946x410x810	952x415x1333
	Packing (WxDxH)	mm	965x395x755	1090x500x865	1090x500x865	1090x500x865	1095x495x1480
	Net/Gross Weight	kg	48/52	67/72	71/76	77/82	102/116
Refrigerant	Type	HFC	R410A	R410A	R410A	R410A	R410A
	Charged Quantity	kg	2.15	3.03	3.3	3.98	4.98
	Chargeless Pipe Length	m	15	22.5	30	37.5	37.5
Additional Refrigerant Charge	Per Linear Metre	kg	0.015	0.015	0.015	0.015	0.015
Design Pressure	Discharge/Suction	MPa	4.2/1.5	4.2/1.5	4.2/1.5	4.2/1.5	4.2/1.5
Refrigerant Piping	Liquid-Side	mm (")	2 x Ø6.35 (2x 1/4")	3 x Ø6.35 (3 x 1/4")	4 x Ø6.35 (4 x 1/4")	5 x Ø6.35 (5 x 1/4")	5 x Ø6.35 (5x 1/4")
	Gas Side	mm (")	2xØ9.52 (2x 3/8")	2xØ9.52+1xØ12.7 (2x3/8" + 1x1/2")	3x Ø9.52+1xØ12.7 (3x3/8" + 1x1/2")	4xØ9.52+1xØ12.7 (4x3/8" + 1x1/2")	3xØ9.52+2xØ12.7 (3x3/8" + 2x1/2")
	Max. Length for All Rooms	m	30	45	60	75	75
	Max. Length for One Indoor Unit	m	20	25	30	30	30
	Max. Height Difference Between Indoor & Outdoor Unit	ODU Higher Than IDU - m	10	10	10	10	10
		ODU Lower Than IDU - m	15	15	15	15	15
	Max. Height Difference Between Indoor Units	m	10	10	10	10	10
Ambient Operation Temperatures	Cooling	°C	-15 ~ 50	-15 ~ 50	-15 ~ 50	-15 ~ 50	-15~ 50
	Heating	°C	-15 ~ 24	-15~ 24	-15 ~ 24	-15 ~ 24	-15 ~ 24

Note: Thermal Data & Performances are based on the following Outdoor and Indoor unit connections:

LNMT052V2 → 2 x LNMTE026V2

LNMT106V2 → 5 x LNMTE026V2

LNMT075V2 → 3 x LNMTE026V2

LNMT135V2 → 4 x LNMTE026V2 + 1 x LNMTE035V2

LNMT086V2 → 4 x LNMTE026V2

Note : Specifications may change without notice. Please refer to your Heatcraft Account Manager / Field Engineer for further clarifications where required.

* Thermal data is in accordance with AS/NZS3823.1.4 & AS/NZS3823.2 standards.

Wall Split Indoor Unit



The classic, contemporary wall split indoor unit with in-built LED display is designed to complement most interiors.







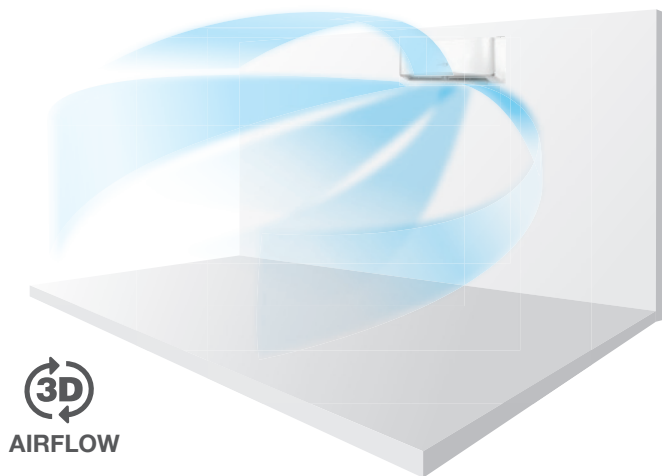

Features & Benefits

Better Comfort

Advanced 3D airflow improves air circulation and minimises hot or cold spots within a room. The powerful 12m air throw is ideal for large open plan rooms.



3D
AIRFLOW

-  12 Grades Indoor Fan Speeds
-  Turbo Mode
-  Low Ambient Cooling
-  Anti-cold Air Function
-  Auto Swing
-  Two-directional Airflow
-  Follow Me
-  3D Airflow

Follow Me

The Follow Me function is ideal for improving comfort wherever you are in the room. Simply press the Follow Me button, and the remote controller acts as your secondary thermostat. This is ideal for minimising hot or cold spots in larger rooms.



Without Follow Me

With Follow Me

Energy Saving

-  Demand Response Enabling Device Compatible (on ODU)

Optional Wi-Fi®

The Wi-Fi® option allows you to control your air-conditioner from your smart phone.

-  Wi-Fi® Control

Cleaner Air

The high density filter catches most airborne particulates such as dust and other allergens.



High Density Filter



User Friendly



Auto Restart Function



2-way Drainage



Louvre Position Memory Function



Manual Switch Button



Timer



Digital Display



I-Remote



Mute Operation

Performance Specifications*

Model Number (Reverse Cycle)	Indoor Unit - Wall Split	Units	LNMT026V2	LNMT035V2	LNMT050V2	LNMT070V2
Cooling	Capacity	kW	2.6	3.5	5	7.1
	Input Power	W	20	30	30	58
	Current	A	0.1	0.13	0.13	0.3
Heating	Capacity	kW	2.7	3.6	5.2	7.5
	Input Power	W	20	32	32	60
	Current	A	0.11	0.15	0.15	0.33
Indoor Fan Motor	Number of Fan Motors	Qty	1	1	1	1
	Output	W	20	20	30	58
	Speed (Turbo/Hi/Med/Lo/Silence)	r/min	1220 / 1100 / 1000 / 750 / 700	1220 / 1100 / 1000 / 750 / 700	1200 / 1100 / 800 / 700 / 650	1200 / 1100 / 900 / 700 / 650
Indoor Coil	Number of Rows	Qty	2	2	2	2
	Tube Pitch(a) x Row Pitch(b)	mm	21x13.37	21x13.37	21x13.37	21x13.37
	Fin Spacing	mm	1.3	1.3	1.2	1.3
	Fin Type (code)	Material	Hydrophilic Aluminium	Hydrophilic Aluminium	Hydrophilic Aluminium	Hydrophilic Aluminium
	Tube OD & Type	mm	Ø7,inner groove tube	Ø7,inner groove tube	Ø7,inner groove tube	Ø7,inner groove tube
	Coil Length x Height x Width	mm	605x294x26.74	605x294x26.74	750x336x26.74	820x336x26.74
	Number of Circuits	Qty	2	2	4	4
Power Supply		V-ph-Hz	220~240-1-50	220~240-1-50	220~240-1-50	220~240-1-50
Indoor Air Flow (Turbo/Hi/Med/Lo/Silence)		L/Sec.	166/161/133/105/77	194/180/158/116/97	333/305/263/211/158	402/386/355/241/208
Indoor Noise Level (Turbo/Hi/Med/Lo/Silence)		dB(A)	43/41/35/33/27	44/42/36/34/28	48/46/40/33/30	52/50/45/37/35
Indoor Ingress Protection Rating		IP	IPX0	IPX0	IPX0	IPX0
Indoor Unit	Dimensions (WxDxH)	mm	802x189x297	802x189x297	965x218x319	1080x226x336
	Packing (WxDxH)	mm	875x285x375	875x285x375	1045x305x405	1155x315x420
	Net/Gross Weight	kg	8.3/10.7	8.3/10.7	10.7/13.9	13.1/17.2
Design Pressure	Discharge/Suction	MPa	4.2/1.5	4.2/1.5	4.2/1.5	4.2/1.5
Refrigerant Piping	Liquid-Side/Gas-Side	mm (")	Ø6.35/Ø9.5 (1/4"/3/8")	Ø6.35/Ø12.7 (1/4"/1/2")	Ø6.35/Ø12.7 (1/4"/1/2")	Ø9.52/Ø15.9 (3/8"/5/8")
Controller		Standard	Remote	Remote	Remote	Remote
Room Temperatures	Cooling	°C	17~32	17~32	17~32	17~32
	Heating	°C	0~30	0~30	0~30	0~30
Operation Temperatures		°C	17~30	17~30	17~30	17~30

Note : Specifications may change without notice. Please refer to your Heatcraft Account Manager / Field Engineer for further clarifications where required.

* Thermal data is in accordance with AS/NZS3823.1.4 & AS/NZS3823.2 standards.

Mini Cassette Indoor Unit



The minimalist lines of the mini cassette indoor unit is designed to complement most residential or commercial interiors. The low and compact profile of the mini cassette means it can be installed in most applications where roof space is minimal.

Features & Benefits

Better Comfort

Smart inverter technology delivers faster heating and cooling when you need it most. The 4-way airflow improves air circulation and minimises hot or cold spots within a room.



Low Ambient Cooling



Anti-cold Air Function



Auto Swing



Follow Me



4-way Air Flow

Follow me

The Follow Me function is ideal for improving comfort wherever you are in the room. Simply press the Follow Me button, and the remote controller acts as your secondary thermostat. This is ideal for minimising hot or cold spots in larger rooms.



Without Follow Me



With Follow Me

Energy Saving



Demand Response Enabling Device Compatible (on ODU)

Health



High Density Filter

User Friendly



Auto Restart Function



Timer



Digital Display



I-Remote



Performance Specifications*

Model Number (Reverse Cycle)	Indoor Unit - Mini Cassette	Units	LNMTCAS020V2	LNMTCAS026V2	LNMTCAS035V2	LMTCAS052V2
Cooling	Capacity	kW	2.0	2.6	3.5	5.2
	Input Power	W	40	40	50	50
	Current	A	0.18	0.18	0.23	0.23
Heating	Capacity	kW	2.3	2.9	3.8	5.5
	Input Power	W	40	40	50	50
	Current	A	0.18	0.18	0.23	0.23
Indoor Fan Motor	Nummber of Fan Motors	Qty	1	1	1	1
	Output	W	46	46	46	46
	Speed	r/min	730 / 620 / 560	730 / 620 / 560	810 / 710 / 650	810 / 710 / 650
Indoor Coil	Number of Rows	Qty	1	1	1	1
	Tube Pitch(a) x Row Pitch(b)	mm	21 x 13.37	21 x 13.37	21 x 13.37	21 x 13.37
	Fin Spacing	mm	1.3	1.3	1.3	1.3
	Fin Type	Material	Hydrophilic Aluminium	Hydrophilic Aluminium	Hydrophilic Aluminium	Hydrophilic Aluminium
	Tube OD & Type	mm	Ø7,inner grooved tube	Ø7,inner grooved tube	Ø7,inner grooved tube	Ø7,inner grooved tube
	Coil Length x Height x Width	mm	1380 x 210 x 13.37	1380 x 210 x 13.37	1380 x 210 x 13.37	1360 x 210 x 26.74
	Number of Circuits	Qty	2	2	2	4
Power Supply		V-Ph-Hz	220~240-1-50	220~240-1-50	220~240-1-50	220~240-1-50
Indoor Airflow	Hi/Med/Lo	L/Sec	186/141/116	186/141/116	211/180/140	211/180/147
Indoor Noise Level	Hi/Med/Lo	dB(A)	43/39/36	43/39/36	48/43/41	48/43/41
Indoor Unit	Dimensions (WxDxH) (body)	mm	570 x 570 x 260	570 x 570 x 260	570 x 570 x 260	570 x 570 x 260
	Packing (WxDxH) (body)	mm	655 x 655 x 290	655 x 655 x 290	655 x 655 x 290	655 x 655 x 290
	Dimensions (WxDxH) (panel)	mm	647 x 647 x 50	647 x 647 x 50	647 x 647 x 50	647 x 647 x 50
	Packing (WxDxH) (panel)	mm	715 x 715 x 123	715 x 715 x 123	715 x 715 x 123	715 x 715 x 123
	Net/Gross Weight (body)	kg	14.5 / 17.3	14.5 / 17.3	16 / 19	18 / 21
	Net/Gross Weight (panel)	kg	2.5 / 4.5	2.5 / 4.5	2.5 / 4.5	2.5 / 4.5
Design Pressure	Discharge/Suction	MPa	4.2 / 1.5	4.2 / 1.5	4.2 / 1.5	4.2 / 1.5
Drainage Connection	Pipe Size	mm	ODØ25	ODØ25	ODØ25	ODØ25
Refrigerant Piping	Liquid Side / Gas Side	mm (")	Ø6.35 / Ø9.52 (1/4" / 3/8")	Ø6.35 / Ø9.52 (1/4" / 3/8")	Ø6.35 / Ø9.52 (1/4" / 3/8")	Ø6.35/Ø12.7 (1/4" / 1/2")
Controller		Standard	Remote	Remote	Remote	Remote
Room Temperatures	Cooling	°C	17 ~ 32	17 ~ 32	17 ~ 32	17 ~ 32
	Heating	°C	0 ~ 30	0 ~ 30	0 ~ 30	0 ~ 30
Operation Temperatures		°C	17 ~ 30	17 ~ 30	17 ~ 30	17 ~ 30

Note : Specifications may change without notice. Please refer to your Heatcraft Account Manager / Field Engineer for further clarifications where required.

* Thermal data is in accordance with AS/NZS3823.1.4 & AS/NZS3823.2 standards.

Slimline Ducted Indoor Unit



For comfort you can depend on, the slimline ducted indoor unit is discreetly installed in your low roof / bulkhead spaces to provide effortless heating and cooling all-year-round.

Features & Benefits

Better Comfort

Smart inverter technology delivers faster heating and cooling when you need it most.



Variable Indoor Fan Speeds



Low Ambient Cooling



Anti-cold Air Function

User Friendly



Auto Restart Function



Timer

Energy Saving



Demand Response Enabling Device Compatible (on ODU)

Health



High Density Filter

Slimline Design

The low slimline profile allows the indoor unit to be installed in tight roof ceiling / bulkhead spaces.





Performance Specifications*

Model Number (Reverse Cycle)	Indoor Unit - Slimline Ducted	Units	LNMTDSS020V2	LNMTDSS026V2	LNMTDSS035V2	LNMTDSS052V2	LNMTDSS070V2
Cooling	Capacity	kW	2.0	2.6	3.5	5.2	7.0
	Input Power	W	30	40	50	80	100
	Current	A	0.13	0.18	0.23	0.37	0.46
Heating	Capacity	kW	2.3	2.9	3.8	5.5	7.3
	Input Power	W	30	40	50	80	100
	Current	A	0.13	0.18	0.23	0.37	0.46
Indoor Fan Motor	Number of Fan Motors	Qty	1	1	1	1	1
	Output	W	55	55	55	90	90
	Speed (Hi/Med/Lo)	r/min	1100/950/850	1100/950/850	1150/1000/900	1050/880/800	1050/880/800
Indoor Coil	Number of Rows	Qty	3	3	3	3	4
	Tube Pitch(a) x Row Pitch(b)	mm	21x13.37	21x13.37	21x13.37	21x13.37	21x13.37
	Fin Spacing	mm	1.5	1.5	1.5	1.5	1.5
	Fin Type (code)	Material	Hydrophilic Aluminium	Hydrophilic Aluminium	Hydrophilic Aluminium	Hydrophilic Aluminium	Hydrophilic Aluminium
	Tube OD & Type	mm	Ø7, inner grooved tube	Ø7, inner grooved tube	Ø7, inner grooved tube	Ø7, inner groove tube	Ø7, inner groove tube
	Coil Length x Height x Width	mm	515x252x40.11	515x252x40.11	515x252x40.11	733x252x40.11	733x252x53.48
	Number of Circuits	Qty	4	4	4	4	6
Power Supply		V-Ph-Hz	220~240-1-50	220~240-1-50	220~240-1-50	220~240-1-50	220~240-1-50
Indoor Airflow	Hi/Med/Lo	L/Sec.	166/150/127	166/150/127	200/166/150	222/169/144	388/333/302
External Static Pressure	Rated	Pa	25	25	25	25	25
	Range	Pa	0-40	0-40	0-40	0-60	0-80
Indoor Noise Level	Hi/Med/Lo	dB(A)	36/33/30	36/33/30	39/36/34	42/39/37	45/41/38
Indoor Unit	Dimension (WxDxH)	mm	700x635x210	700x635x210	700x635x210	920x635x210	920x635x270
	Packing (WxDxH)	mm	915x655x290	915x655x290	915x655x290	1135x655x290	1135x655x350
	Net/Gross Weight	kg	18.5/23.1	18.1/22.8	18.1/22.8	23/29	28/31.5
Design Pressure	Discharge/Suction	MPa	4.2/1.5	4.2/1.5	4.2/1.5	4.2/1.5	4.2/1.5
Drain Connection	Pipe Size	mm	ODØ25	ODØ25	ODØ25	ODØ25	ODØ25
Refrigerant Piping	Liquid Side / Gas Side	mm (")	Ø6.35/Ø9.52 (1/4"/3/8")	Ø6.35/Ø9.52 (1/4"/3/8")	Ø6.35/Ø9.52 (1/4"/3/8")	Ø6.35/Ø12.7 (1/4"/1/2")	Ø9.52/Ø15.9 (3/8"/5/8")
Controller		Standard	Wired	Wired	Wired	Wired	Wired
Room Temperatures	Cooling	°C	17~32	17~32	17~32	17~32	17~32
	Heating	°C	0~30	0~30	0~30	0~30	0~30
Operation Temperatures		°C	17~30	17~30	17~30	17~30	17~30

Note : Specifications may change without notice. Please refer to your Heatcraft Account Manager / Field Engineer for further clarifications where required.

* Thermal data is in accordance with AS/NZS3823.1.4 & AS/NZS3823.2 standards.

Controls



i-Remote controller available for wall split and mini cassette indoor units.



Optional Wi-Fi® controller allows you to operate your air conditioner using your smartphone or device.
(Available for wall split indoor units only).



Wall controller available for slimline ducted units only.





4G

3:37 pm

ACAA61

82%

24°C
COOL

Fan
Indoor 17°C

MODE



Turbo



Lennox is a leading global name in climate control solutions. The Lennox range offers a solution for any HVAC application and includes residential air conditioners, furnaces and heat pumps, plus commercial packaged units, air handling systems, chillers, comfort controls and indoor air quality systems.

All Lennox equipment is designed to optimise energy efficiency, cost of ownership and ease of installation.

With over 120 years of manufacturing history you can purchase Lennox with confidence that we are continually providing innovation, quality products and services.

LENNOXMULTISPLITSYSTEM_0817

australia

13 23 50

lennoxaustralia.com.au

new zealand

0800 653 330

lennoxnz.co.nz

Exclusively distributed by



The contents of this brochure are copyright protected and may not be reproduced in any form without the written consent of Heatcraft. Recommendations and advice regarding the use of the products described in this publication are to be taken as a guide only and are given without liability on the part of the company or its employees. As Heatcraft continually improves its product range and processes, Heatcraft reserves the right to change product specifications without any prior notification. Please refer to the Heatcraft website for the latest version of this publication. The purchaser should independently determine the suitability of the product for the intended use and application and that the product complies with relevant standards. Heatcraft accepts no responsibility for loss or damage (direct or indirect and including consequential loss, loss of profits or opportunity and economic loss) however arising which results from any errors or omissions in the information contained in this publication or arising from the use or application of the information contained herein.